

INTRODUCING...

LYON TECHNOLOGY PARK

54500-54650 GRAND RIVER AVENUE
NEW HUDSON, MICHIGAN



BUILDING FEATURES

- + New Construction - Build to Suit
- + Excellent Corporate Image
- + 100,000 up to 500,000 SF
- + Zoned Light Industrial
- + 30' to 32' Ceiling Heights
- + 10' x 10' Dock Doors
- + I-96 Frontage
- + Excellent Access to I-96

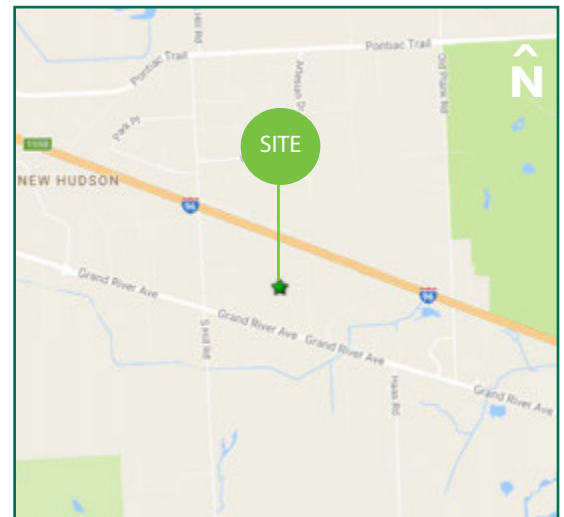

CONTACT US

DAVID GILTNER

First Vice President
+1 248 936 6828
david.giltner@cbre.com

RANDALL ALLMAN, SIOR

First Vice President
+1 248 351 2062
randall.allman@cbre.com

PETER ROGERS, SIOR

Vice President
+1 248 351 2064
peter.rogers@cbre.com

www.cbre.com/Detroit



CBRE

INTRODUCING...

LYON TECHNOLOGY PARK

54500-54650 GRAND RIVER AVENUE
NEW HUDSON, MICHIGAN

AERIAL



CONTACT US

DAVID GILTNER

First Vice President
+1 248 936 6828
david.giltner@cbre.com

RANDALL ALLMAN, SIOR

First Vice President
+1 248 351 2062
randall.allman@cbre.com

PETER ROGERS, SIOR

Vice President
+1 248 351 2064
peter.rogers@cbre.com

www.cbre.com/Detroit



CBRE

INTRODUCING...

LYON TECHNOLOGY PARK

54500-54650 GRAND RIVER AVENUE
NEW HUDSON, MICHIGAN

PROPOSED SITE PLAN FOR 500,000 SF

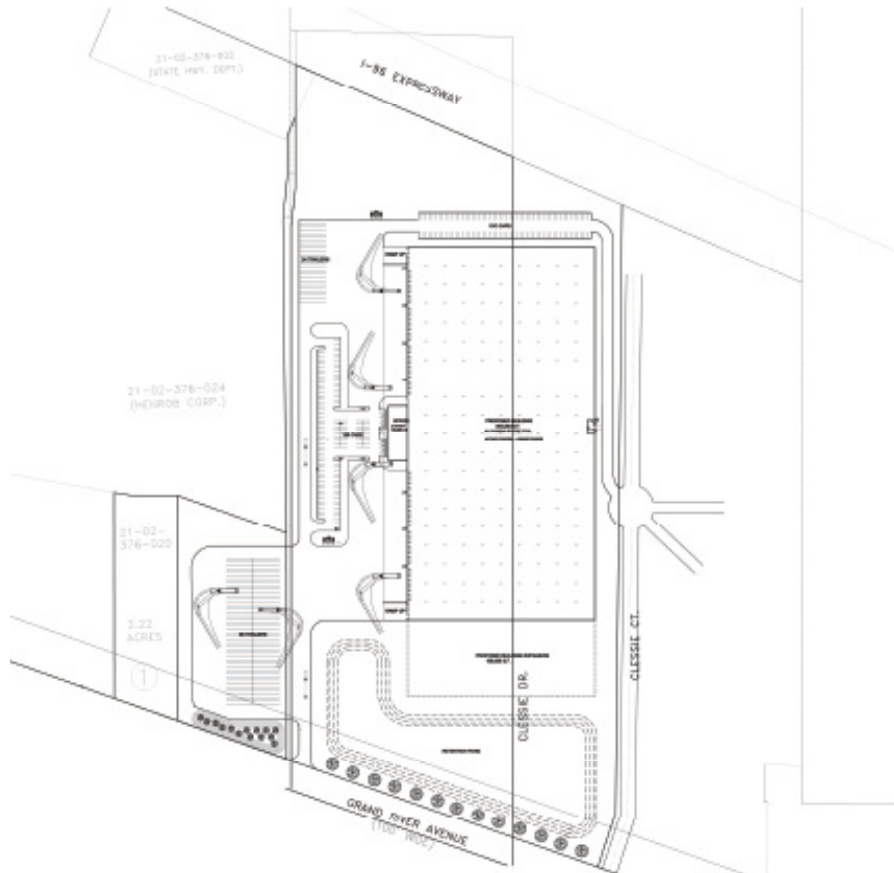

CONTACT US

DAVID GILTNER

First Vice President
+1 248 936 6828
david.giltner@cbre.com

RANDALL ALLMAN, SIOR

First Vice President
+1 248 351 2062
randall.allman@cbre.com

PETER ROGERS, SIOR

Vice President
+1 248 351 2064
peter.rogers@cbre.com

www.cbre.com/Detroit



CBRE

INTRODUCING...

LYON TECHNOLOGY PARK

54500-54650 GRAND RIVER AVENUE
NEW HUDSON, MICHIGAN

PROPOSED SITE PLAN FOR (3) 100,000 SF, 133,000 SF & 150,000 SF W/ EXPANSION

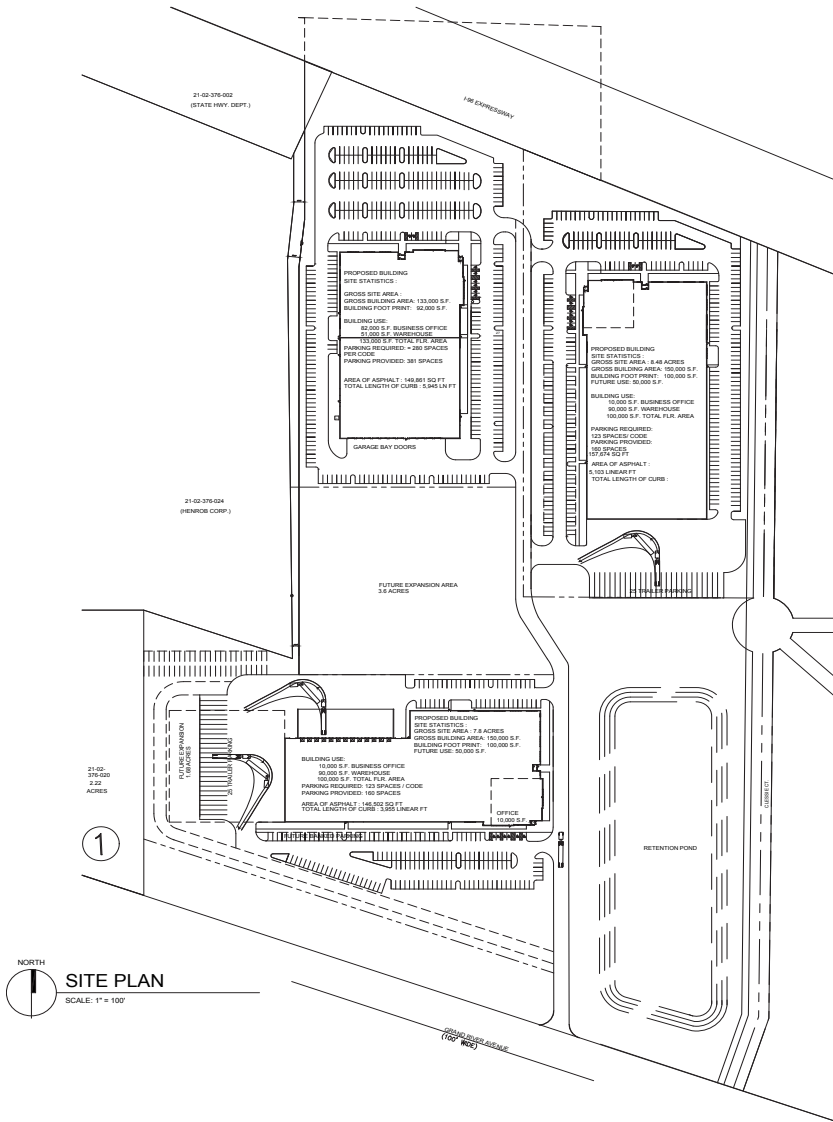

biddison |
architecture + design
300 Main St., Suite 10
Birmingham, AL 35203
1.248.554.9000

Consultants

GENERAL CONTRACTOR



DESIGN | BUILD | DEVELOP

Project title

PROPOSED BUILDING FOR:

Issued d/rev

REVIEW 09.09.16

Sheet title

SITE PLAN

Project no.

1953-16

Sheet no.

NORTH
SITE PLAN
SCALE: 1" = 100'



CONTACT US

DAVID GILTNER
First Vice President
+1 248 936 6828
david.giltner@cbre.com

RANDALL ALLMAN, SIOR
First Vice President
+1 248 351 2062
randall.allman@cbre.com

PETER ROGERS, SIOR
Vice President
+1 248 351 2064
peter.rogers@cbre.com

www.cbre.com/Detroit



CBRE

INTRODUCING...

LYON TECHNOLOGY PARK

54500-54650 GRAND RIVER AVENUE
NEW HUDSON, MICHIGAN

AREA AMENITIES



CONTACT US

DAVID GILTNER

First Vice President
+1 248 936 6828
david.giltner@cbre.com

RANDALL ALLMAN, SIOR

First Vice President
+1 248 351 2062
randall.allman@cbre.com

PETER ROGERS, SIOR

Vice President
+1 248 351 2064
peter.rogers@cbre.com

www.cbre.com/Detroit



CBRE



PROPERTY OVERVIEW

- + County: Oakland
- + Zoning: Light Industrial
- + Total Building Size: 100,000 up to 500,000 SF
- + Divisible (Min/Max): 100,000 up to 500,000 SF
- + Sale Price / Lease Rate: TBD
- + Taxes: TBD



LAND & STRUCTURES

Year Built:	2017	Parking:	TBD
Total Available:	100,000 up to 500,000 SF	HVAC:	Gas - Roof Unit
Available Office:	Build To Suit	Power:	TBD
Available Shop:	Build To Suit	Security System:	TBD
Divisible:	Yes	Lighting:	T-5
Acreage:	TBD	Restrooms:	TBD
Construction:	Pre Cast Concrete	Grade Level Doors:	2
Stories:	2	Truckwells / Docks:	50 Docks
Floor Drains:	TBD	Cranes:	TBD
Ceiling Height:	30'-32'	Bay Sizes:	Ample



COMMENTS

- + New Construction - Build to Suit
- + Excellent Corporate Image
- + Coming soon; 100,000 up to 500,000 SF
- + Zoned Industrial
- + 30' to 32' Ceiling Heights
- + 10' x 10' Dock Doors
- + I-96 Frontage
- + Excellent Access to I-96



CONTACT US

DAVID GILTNER

First Vice President
+1 248 936 6828
david.giltner@cbre.com

RANDALL ALLMAN, SIOR

First Vice President
+1 248 351 2062
randall.allman@cbre.com

PETER ROGERS, SIOR

Vice President
+1 248 351 2064
peter.rogers@cbre.com